

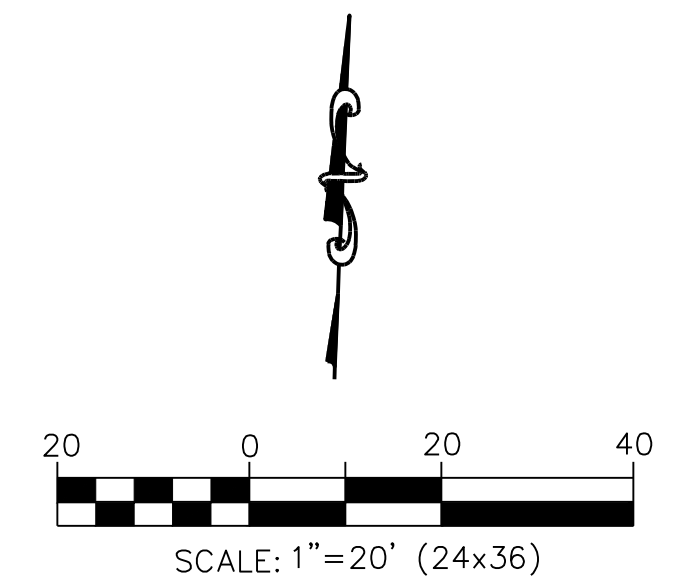

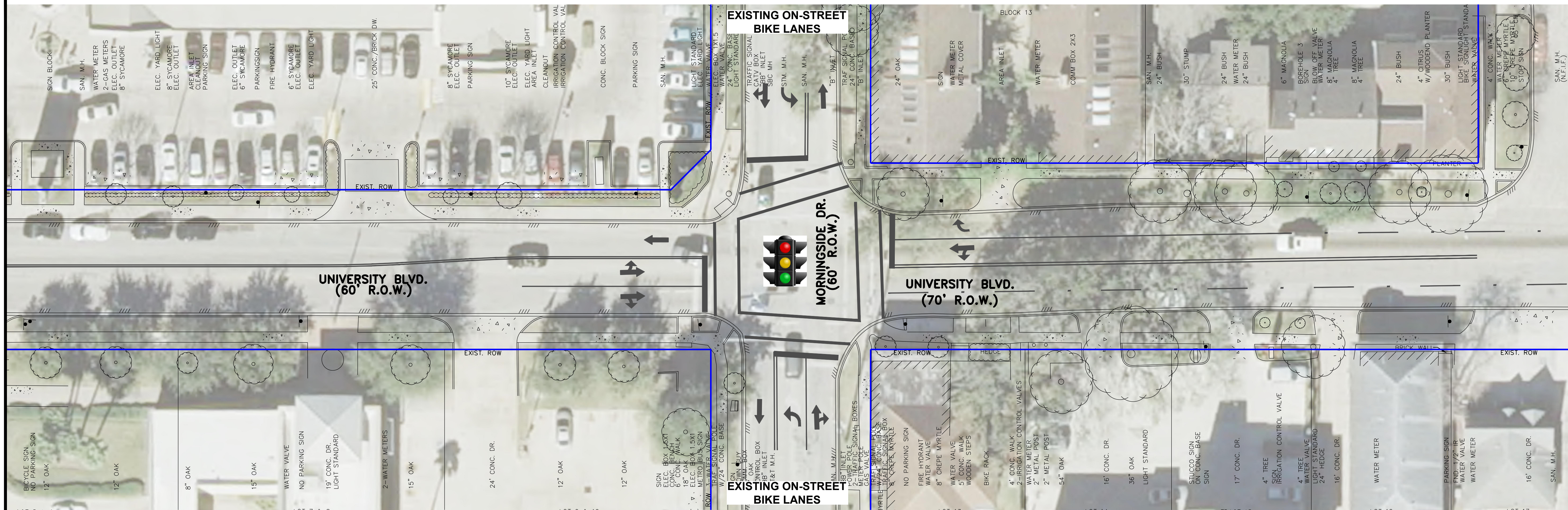





# EXISTING MORNINGSIDE DRIVE INTERSECTION



- LEGEND:**
-  PROP/RECONSTRUCTED TRAFFIC SIGNAL
  -  PROP PAVEMENT BACK OF CURB
  -  PROP PAVEMENT EDGE
  -  PROP CONC. PVMT.
  -  PROP SIDEWALK
  -  EXISTING R.O.W.
  -  PROP R.O.W.

# PROPOSED MORNINGSIDE DRIVE INTERSECTION

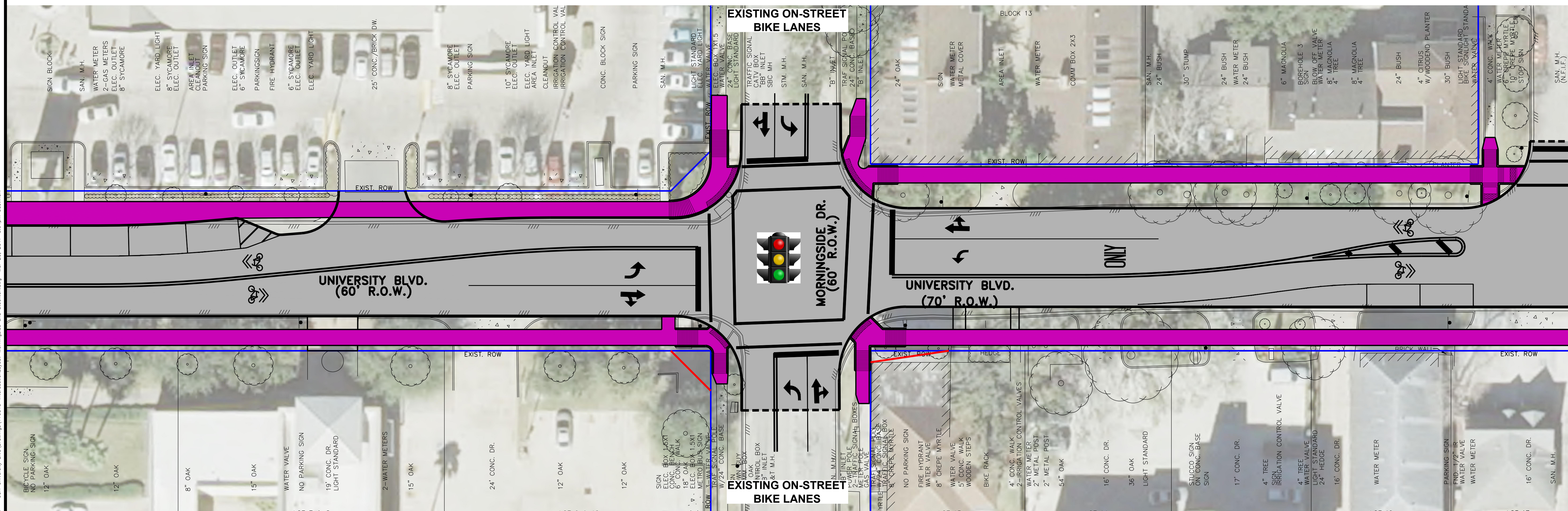

**GC ENGINEERING, INC.**  
 2505 PARK AVENUE, Phone: (281) 412-7008  
 PEARLAND, TEXAS 77581 FAX: (281) 412-4623  
 TBPE Registration No. F-7889

**CITY OF HOUSTON**  
 DEPARTMENT OF PUBLIC WORKS AND ENGINEERING

UNIVERSITY BOULEVARD  
 KIRBY DRIVE TO MAIN STREET  
 PAVING AND DRAINAGE IMPROVEMENTS  
 INTERSECTION LAYOUT  
 MORNINGSIDE DRIVE

Project No.: <b>GCE C-0777</b>	Scale: 1"=20' (24x36)	SHEET NO
Date: <b>MARCH 20, 2017</b>		<b>EXHIBIT 3</b>
Drawn by: <b>BD</b>	Checked by: <b>AMR</b>	

GC Engineering, Inc. M:\Projects\170215-IntersectionLayout-Morningside and Stockton.dwg Mar 20, 2017 - 10:46am bhobbs